

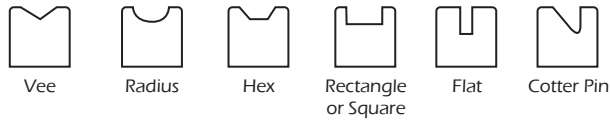

- Highest Groove Accuracy in Industry
- Standard Concentricity .0005" (0,0127 mm). This tolerance minimizes the hairpin wire effect.
- Angle: +/- 30 min.
- Centerline parallel to edge w/in .0005"
- Rolls can be polished and stoned.

### ▶ OPTIONAL ROLL GROOVE DESIGNS



### ▶ TECHNICAL SPECIFICATIONS

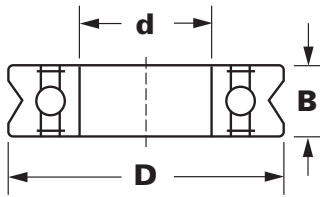

### ▶ METRIC-ROLL

PART NO.	MODEL	WIRE DIAMETER	D	d	B	DISCOUNT PRICE
108066-03	683h-ZZ	.004"-.008" 0,1-0,2 mm	.276" 7 mm	.118" 3 mm	.118" 3 mm	\$6.45
108067-01	GR10	.0032"-.016" 0,08 mm-0,4 mm	.394" 10 mm	.118" 3 mm	.157" 4 mm	\$6.94
108152-05	GR13	.008"-.020" 0,2 mm-0,5 mm	.512" 13 mm	.157" 4 mm	.197" 5 mm	\$3.56
108018-02	GR16	.020"-.031" 0,5 mm-0,8 mm	.630" 16 mm	.157" 4 mm	.197" 5 mm	\$4.34
108080-26	GR22	.031"-.059" 0,8 mm-1,5 mm	.866" 22 mm	.315" 8 mm	.276" 7 mm	\$4.34
108080-67	GR22	.039"-.079" 1,0 mm-2,0 mm	.866" 22 mm	.315" 8 mm	.276" 7 mm	\$4.34
108168-01	GR23	.031"-.059" 0,8 mm-1,5 mm	.906" 23 mm	.315" 8 mm	.276" 7 mm	\$4.34
108181-00	GR26	.039"-.098" 1,0-2,5 mm	1.024" 26 mm	.315" 8 mm	.276" 7 mm	\$19.95
108527-01	GR30	.059"-.118" 1,5 mm-3,0 mm	1.181" 30 mm	.394" 10 mm	.563" 14.3 mm	\$8.84
108191-03	GR31	.071"-.138" 1,8 mm-3,5 mm	1.220" 31 mm	.394" 10 mm	.551" 14 mm	\$16.49
108169-01	GR32	.059"-.157" 1,5-4,0 mm	1.260" 32 mm	.394" 10 mm	.551" 14 mm	\$11.28
108169-20	GR32	.079"-.157" 2,0 mm-4,0 mm	1.260" 32 mm	.394" 10 mm	.551" 14 mm	\$11.28
108128-12	GR35	.098"-.177" 2,5 mm-4,5 mm	1.378" 35 mm	.472" 12 mm	.630" 16 mm	\$19.95
108149-04	GR40	.118"-.197" 3,0 mm-5,0 mm	1.575" 40 mm	.591" 15 mm	.630" 16 mm	\$19.95
108535-04	GR-S10-A	.0015"-.010" 0,038 mm-0,25 mm	.1875" 4,76 mm	.0937" 2,38 mm	.0937" 2,38 mm	\$22.12
108069-01	R2ZZ	.003"-.015" 0,076 mm-0,38 mm	.375" 9,52 mm	.125" 3,17 mm	.1562" 3,97 mm	\$6.08
108070-01	R3ZZ	.015"-.032" 0,38 mm-0,81 mm	.500" 12,7 mm	.1875" 4,76 mm	.196" 4,99 mm	\$6.08
108072-00	R4AZZ	.030"-.062" 0,76 mm-1,57 mm	.750" 19,05 mm	.250" 6,35 mm	.2812" 7,14 mm	\$6.08
108087-01	5201ZZ	.062"-.125" 1,57 mm-3,17 mm	1.259" 32,00 mm	.472" 12,0 mm	.625" 15,87 mm	\$13.01
108093-01	5303ZZ	.125"-.250" 3,17 mm-6,35 mm	1.850" 47,00 mm	.669" 16,99 mm	.875" 22,23 mm	\$22.56



**Sjogren Industries, Inc**  
tel: 508-987-3206 • www.sjogren.com